



Pentland Homes

Discover the difference...



The Gloucester (Plots 98 & 99)

*A stylish 3 bedroom 3 storey home featuring
an open plan lounge/kitchen/diner, study,
en-suite to all bedrooms and dressing room to master suite*

Scholars Village, Park Farm Road, Folkestone CT19 5DN



The Gloucester (Plots 98 & 99)

1386 sq ft

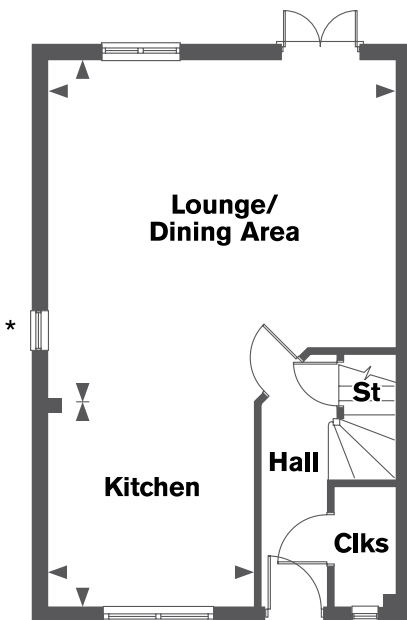

* Window (non opening) with obscure glazing

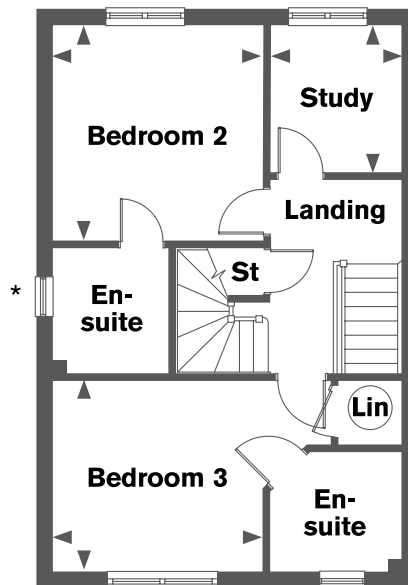

* Window (non opening)

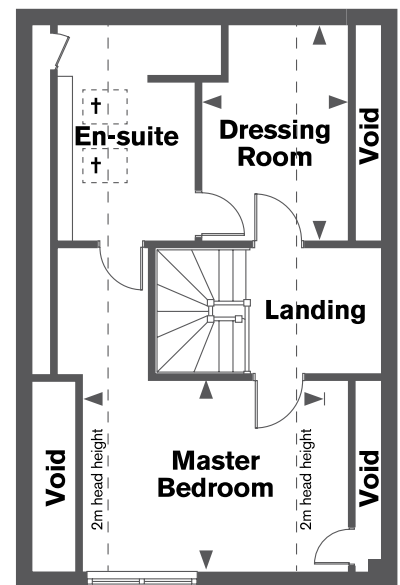

† Rooflight

Ground Floor

Lounge/Dining Area

5505mm x 5415mm (18' 1" x 17' 9")

Kitchen

3265mm x 3255mm (10' 9" x 10' 8")

Cloakroom

First Floor

Bedroom 2

3410mm x 3320mm (11' 2" x 10' 11")

Bedroom 3

3320mm[†] x 3000mm (10' 11"[†] x 9' 10")

Study

2305mm x 2060mm (7' 7" x 6' 9")

Second Floor

Master Bedroom

3770mm x 3000mm (12' 7" x 9' 10")

Dressing Room

3410mm x 2355mm* (11' 2" x 7' 9"*)

*maximum †minimum